

An aerial photograph of the Saint Paul, Minnesota riverfront. The Mississippi River flows through the center, with several bridges crossing it. In the foreground, there are green trees on a grassy hill, a parking lot, and railroad tracks. A road with a car runs parallel to the river. In the background, there are modern buildings and a power line tower. The sky is blue with scattered white clouds.

# RIVER BALCONY SAINT PAUL, MN Schematic Design Update June, 2022

# PROJECT FRAMEWORK MAP

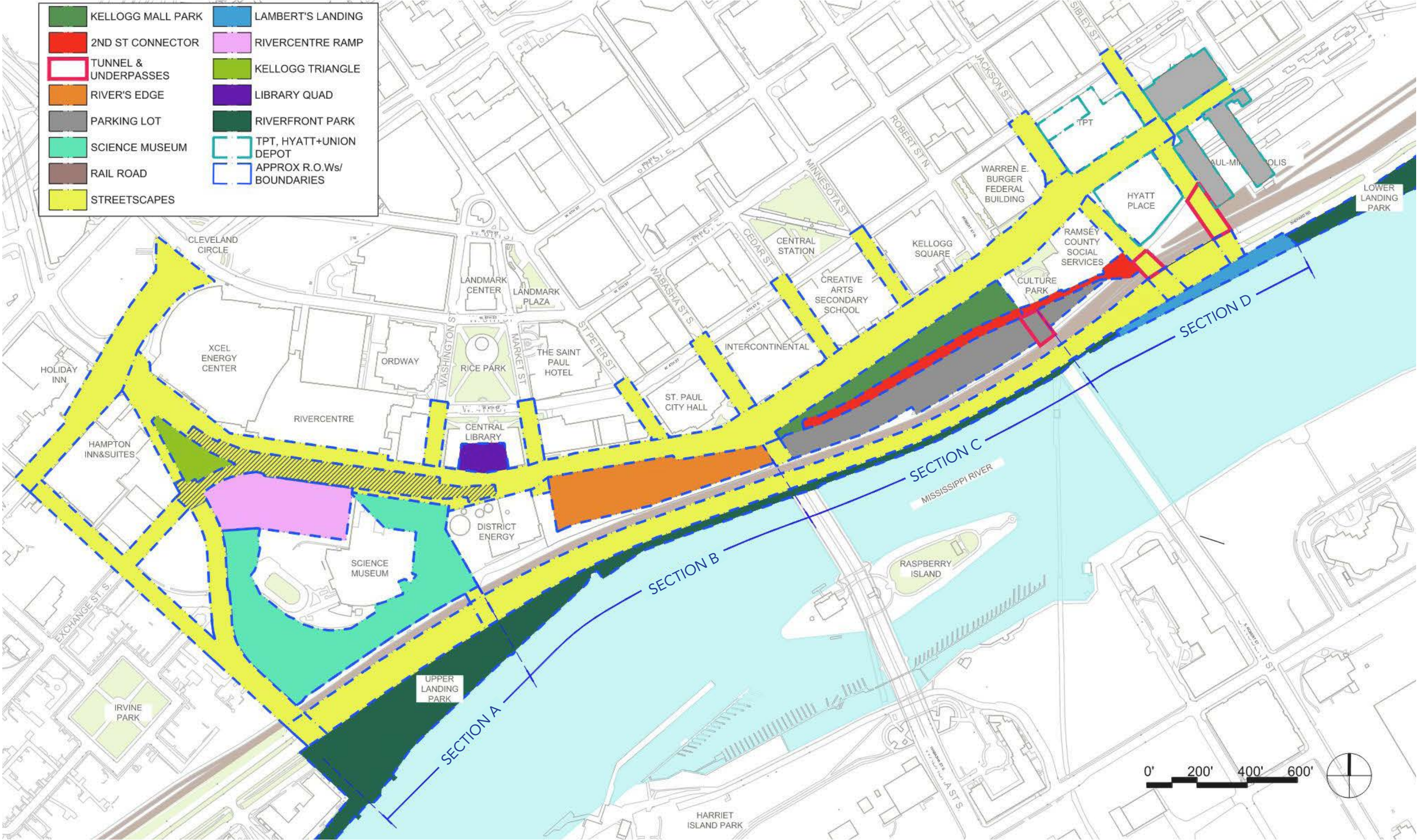

# OVERARCHING PRINCIPLES

- **Build on what is already here**
- **Establish critical connections**
- **Create discrete and distinctive elements**
- **Prolong and extend the stay**
- **Foster programmatic extensions and synergies**
- **Cultivate connection to place and a sense of belonging**
- **Build excitement and activate through interim use**
- **Meet the needs of local communities and residents and attract the larger St. Paul community**



**INSPIRATIONS**

**MISSISSIPPI**



**RIVER LORE**



**COMMUNITY**

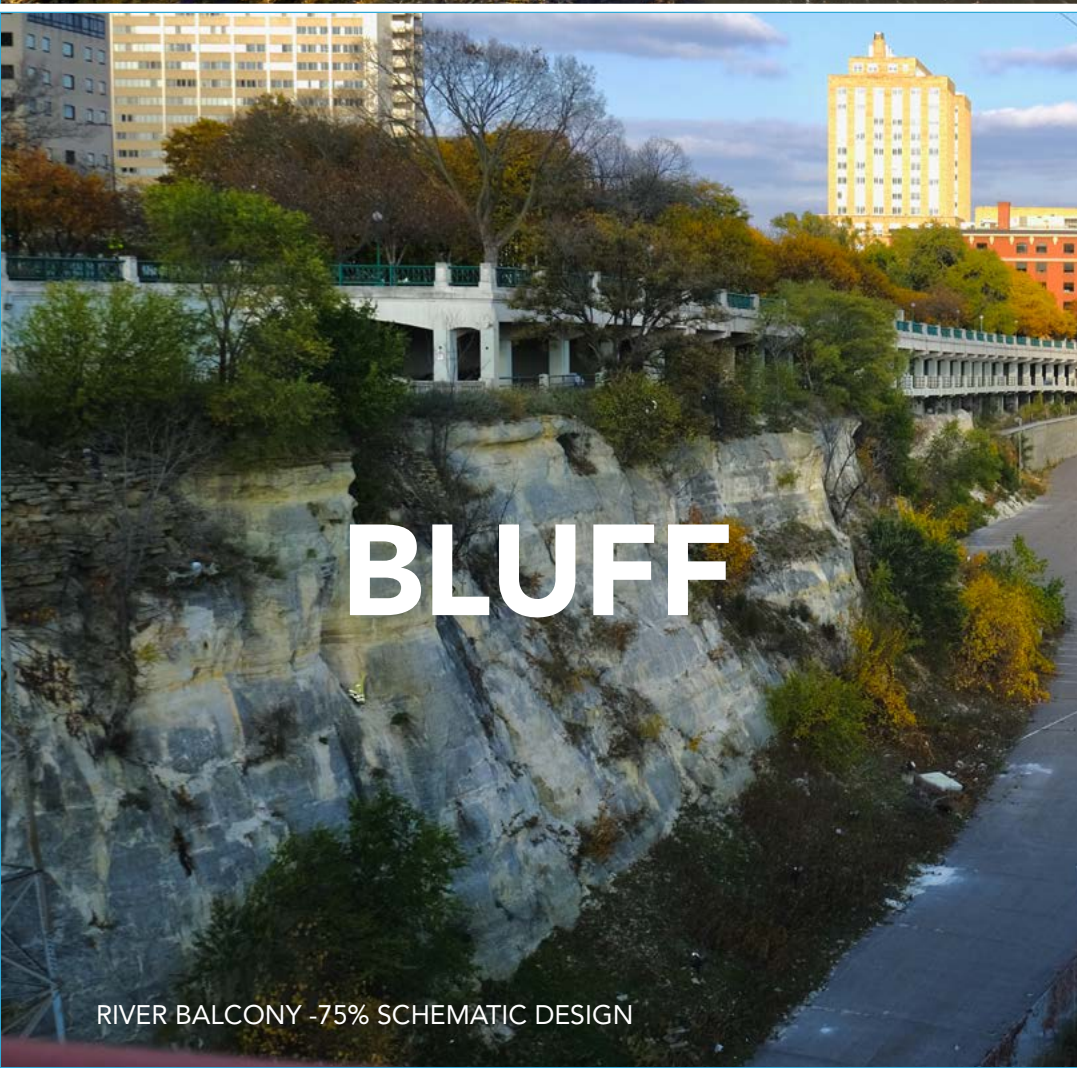

**BLUFF**

RIVER BALCONY -75% SCHEMATIC DESIGN



**ECOREGIONS**

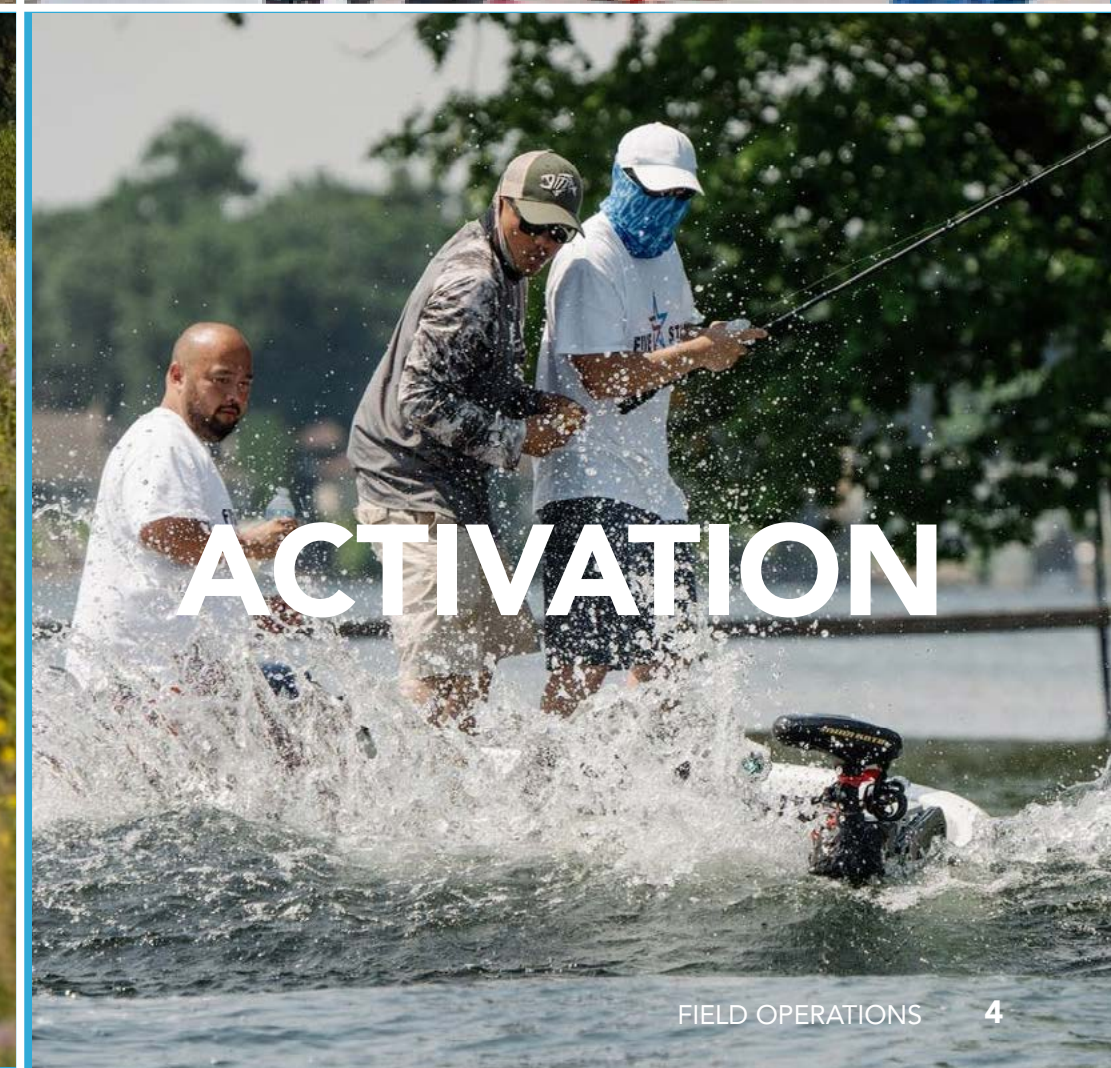

**ACTIVATION**

# TRANSFORMATIVE POTENTIAL OF THE RIVER BALCONY

- **ACCESS:** increase, enhance and strengthen access to the river
- **ACTIVATION:** activate the downtown and riverfront
- **ARMATURE:** connect civic landmarks, public spaces, trails, and development
- **IDENTITY & RIVER LORE:** tell stories, develop and expand St. Paul's narrative around the river, bringing the river to the center of public life

# KEY TAKEAWAYS

- **General support and excitement for the River Balcony project and initial design concepts**
- **Address Shepard Road as current barrier to the river**
- **Increase opportunities for activation and programming**
- **Reinforce City's equity goals**
- **Show how the River Balcony ties into and strengthens the City's open space, trail and bike networks**
- **Provide opportunities for and access to nature and integrate natural materials and elements**
- **Ensure authentic engagement with historically under-represented populations including the Dakota, Hmong, Somali, African American & Latin/Hispanic communities**

# SURVEY 1

## Q1 Top 3 Priorities

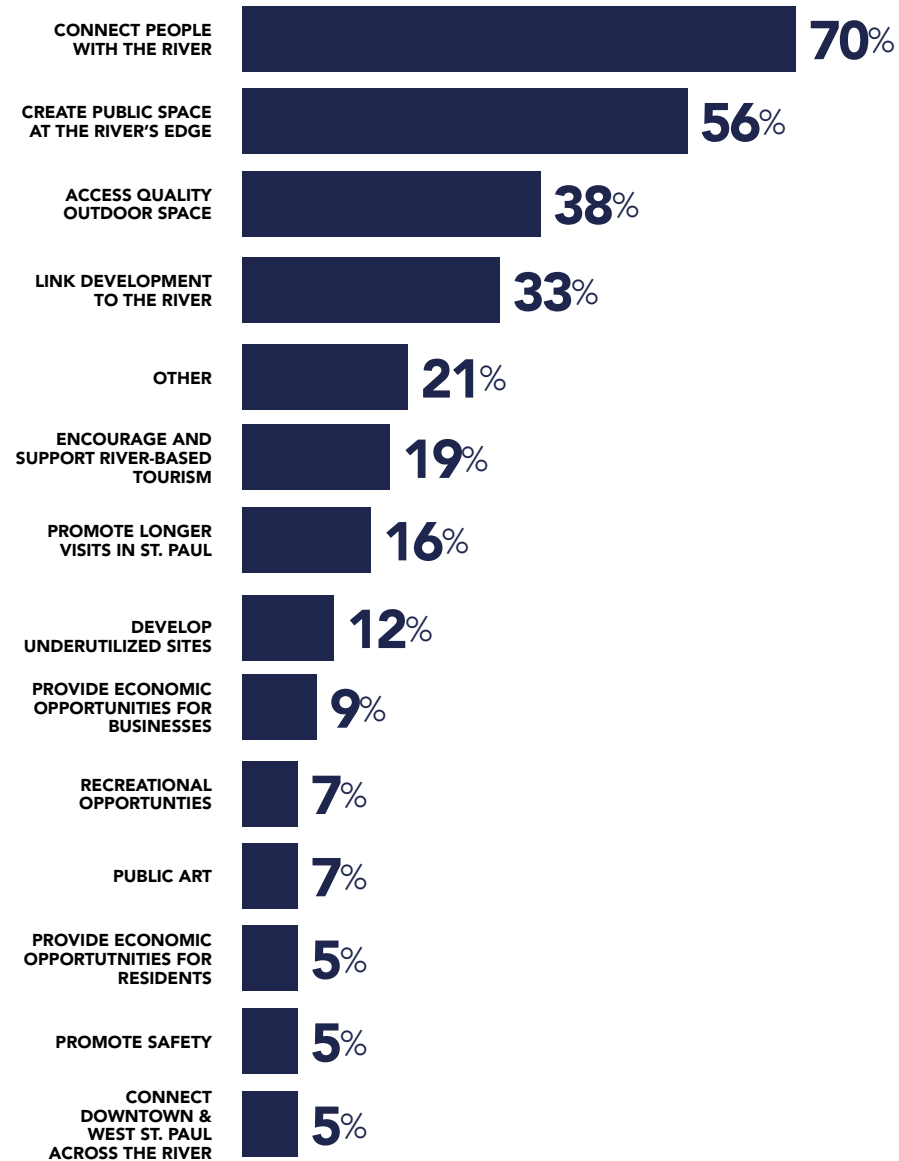

## Q2 Top 2 Concerns

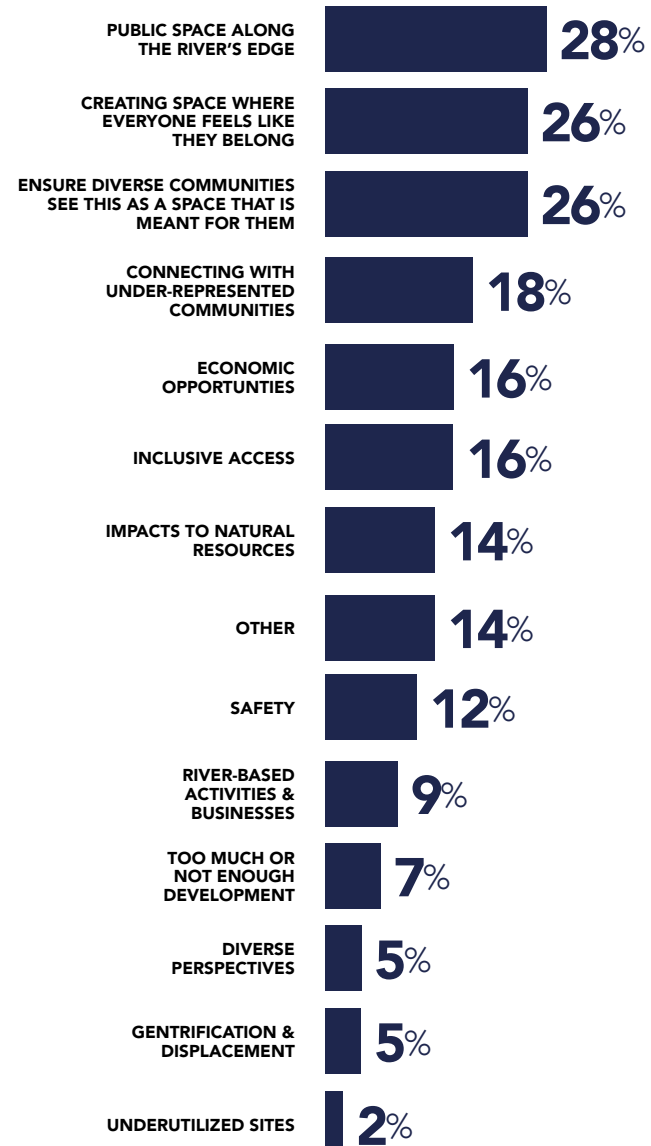

### Q3 What would most attract you?

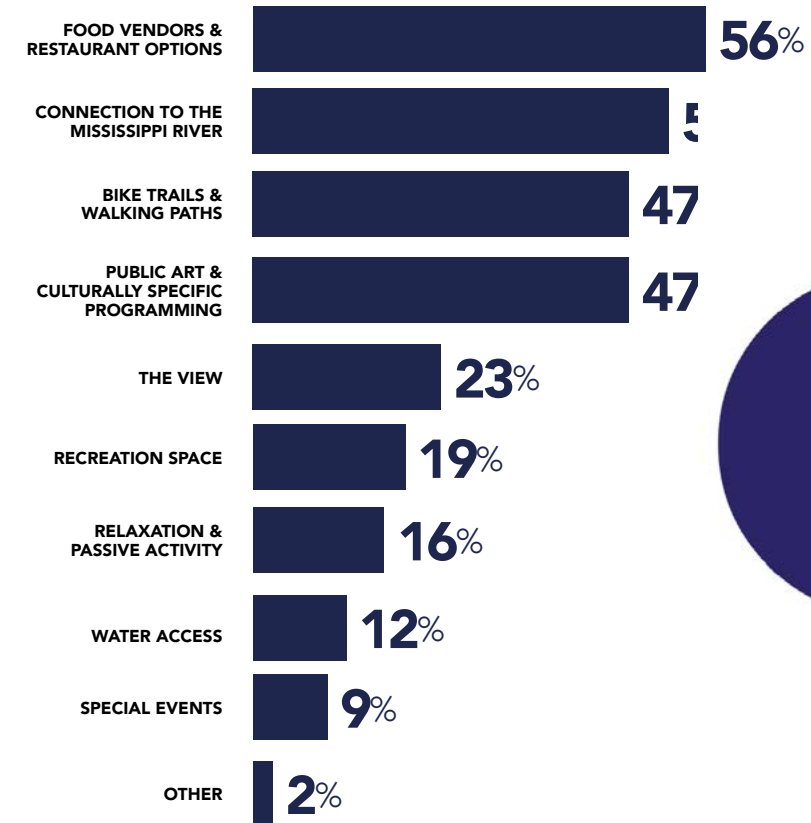

### Q5 What is missing?



## Q4 Top 3 Uses

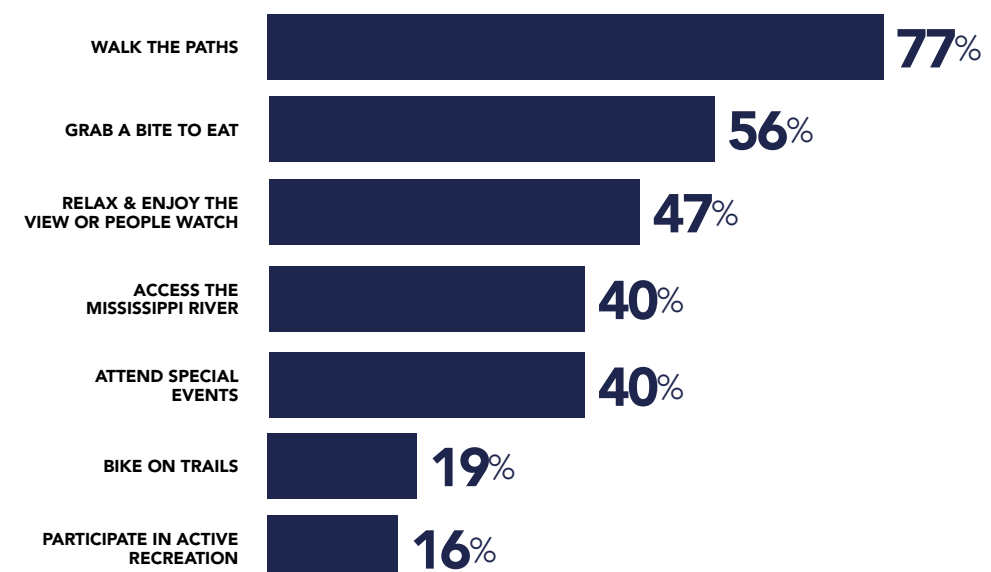

## SURVEY 2

**Q1** Looking at the design, do you feel a stronger connection to the River?



**Q2** The design shows several outdoor and public spaces along the river. Which features excite you the most?

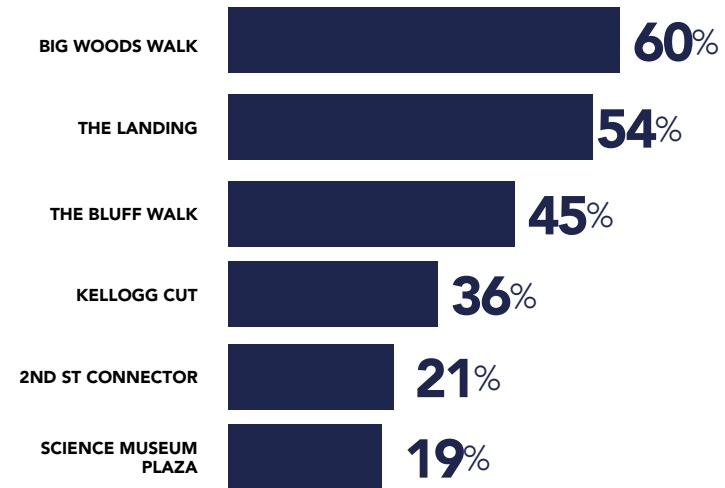

**Q3** What aspect of the River Balcony would you use the most and/or would encourage you to extend your visit to downtown Saint Paul?

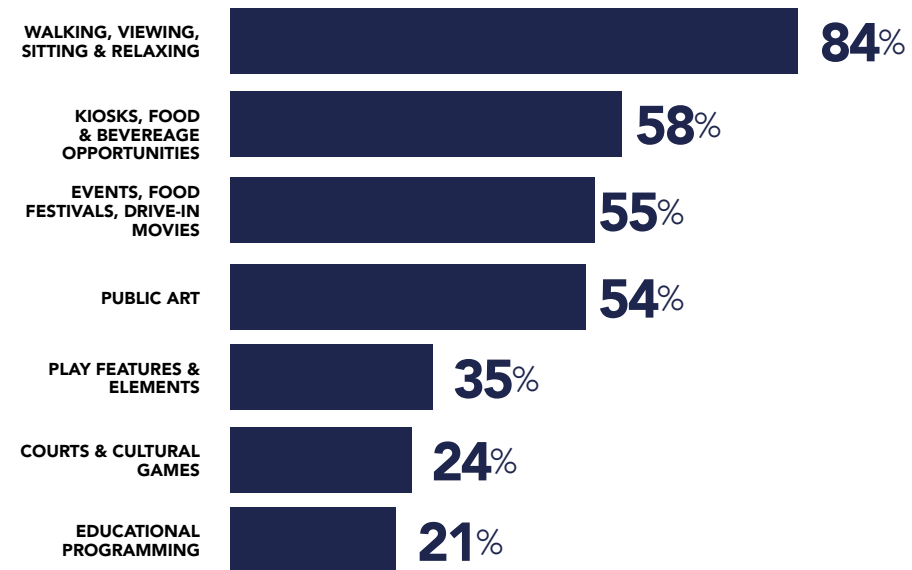

#### Q4 What would you like to see more of in the design?



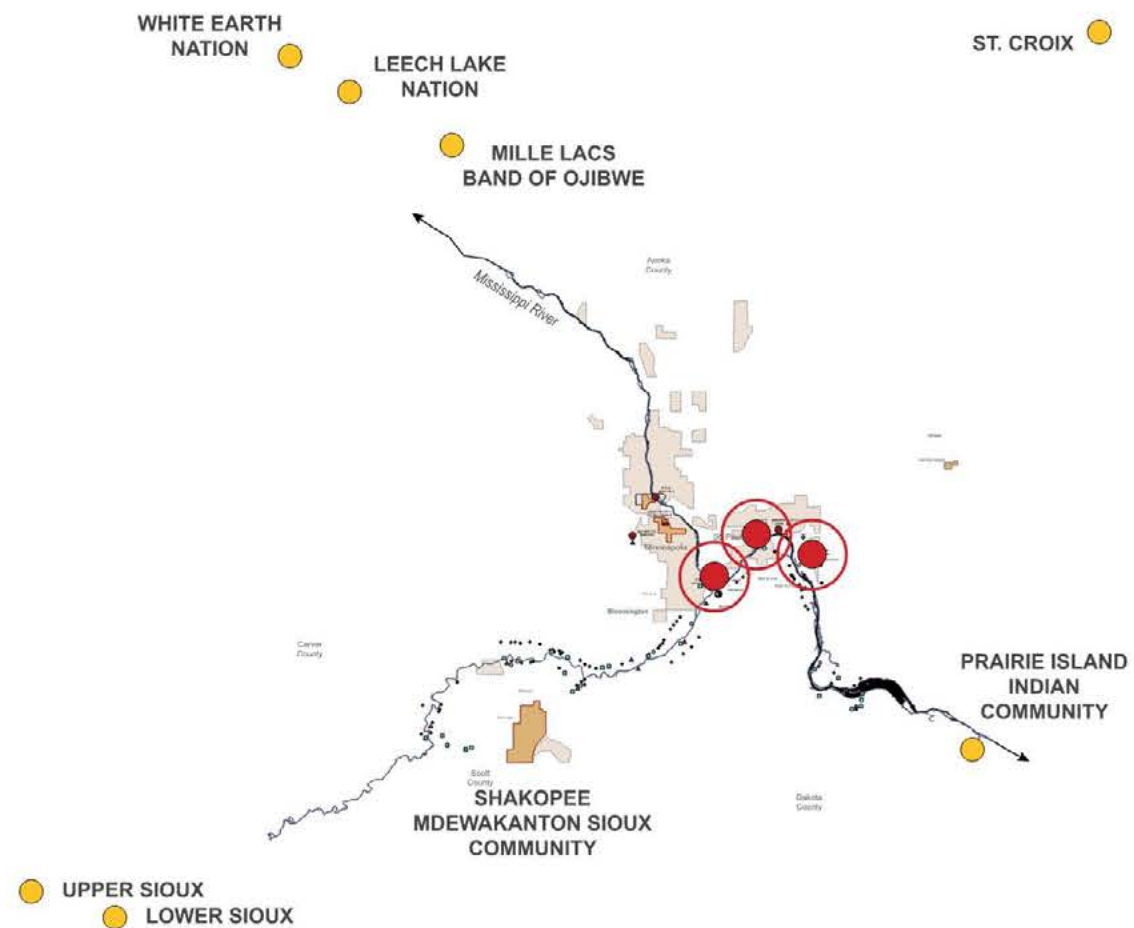

Regional Tribal Communities

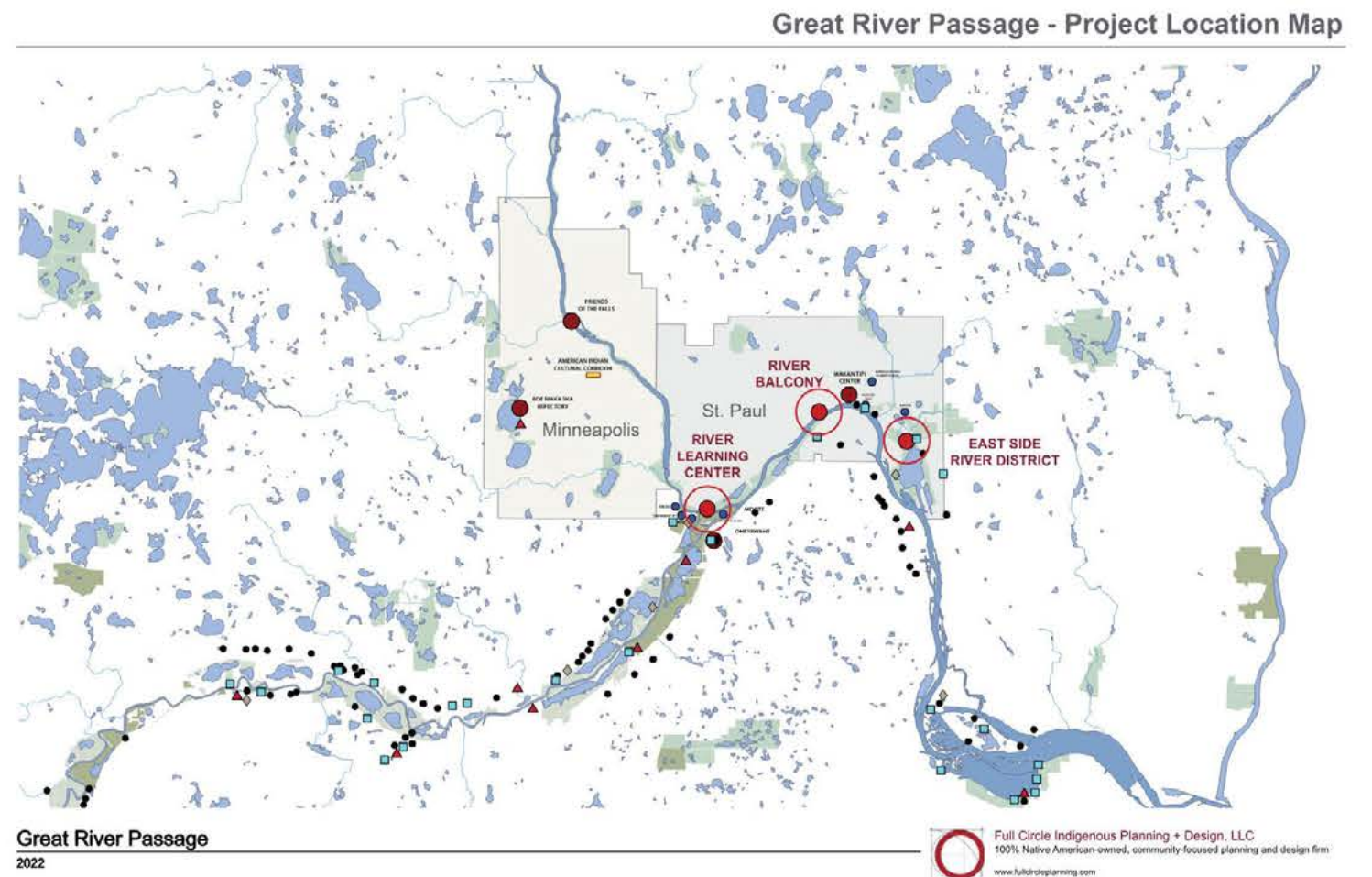

# DAKOTA ENGAGEMENT INITIATIVE

\* DRAFT TIMELINE, DATES MAY CHANGE

## Great River Passage - Conceptual Design Timelines

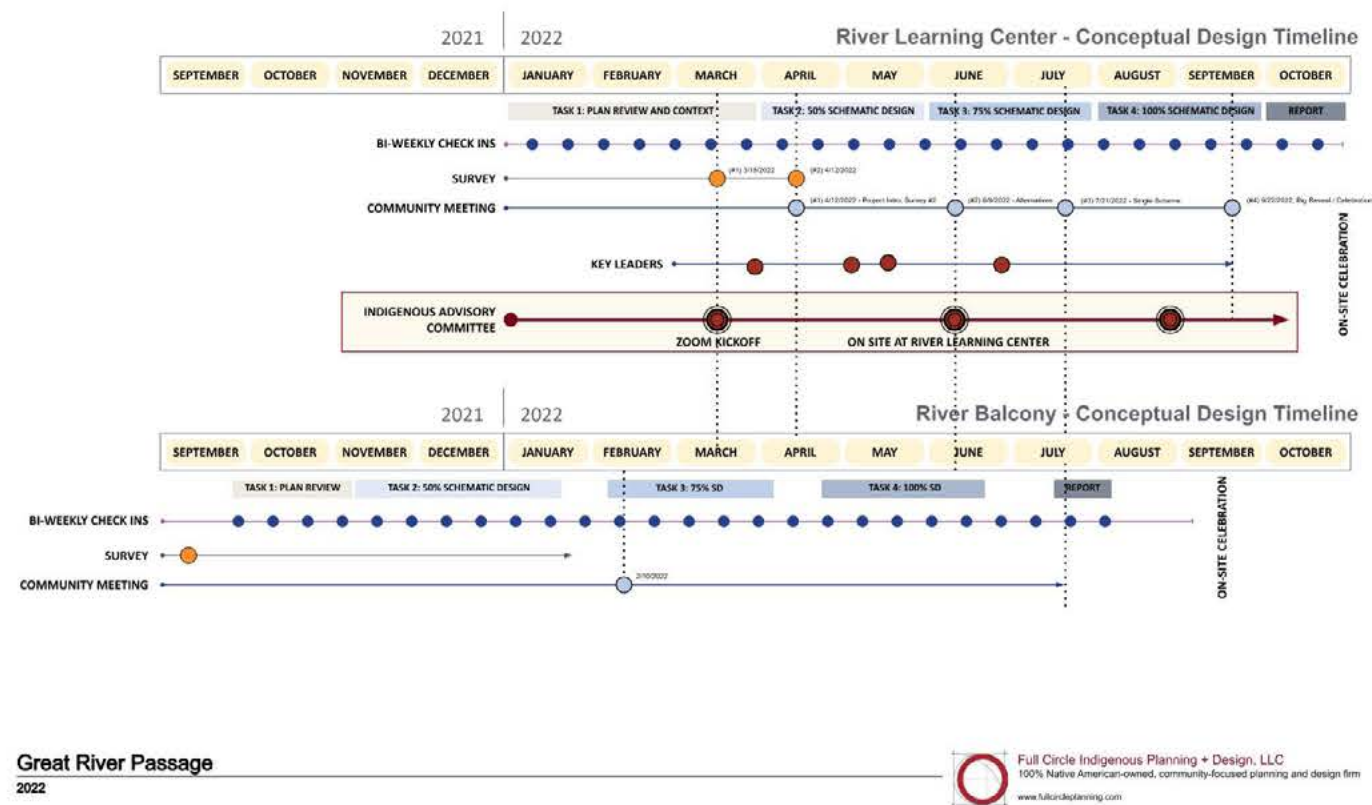

Great River Passage  
2022

## Great River Passage - Indigenous-Led Community Engagement

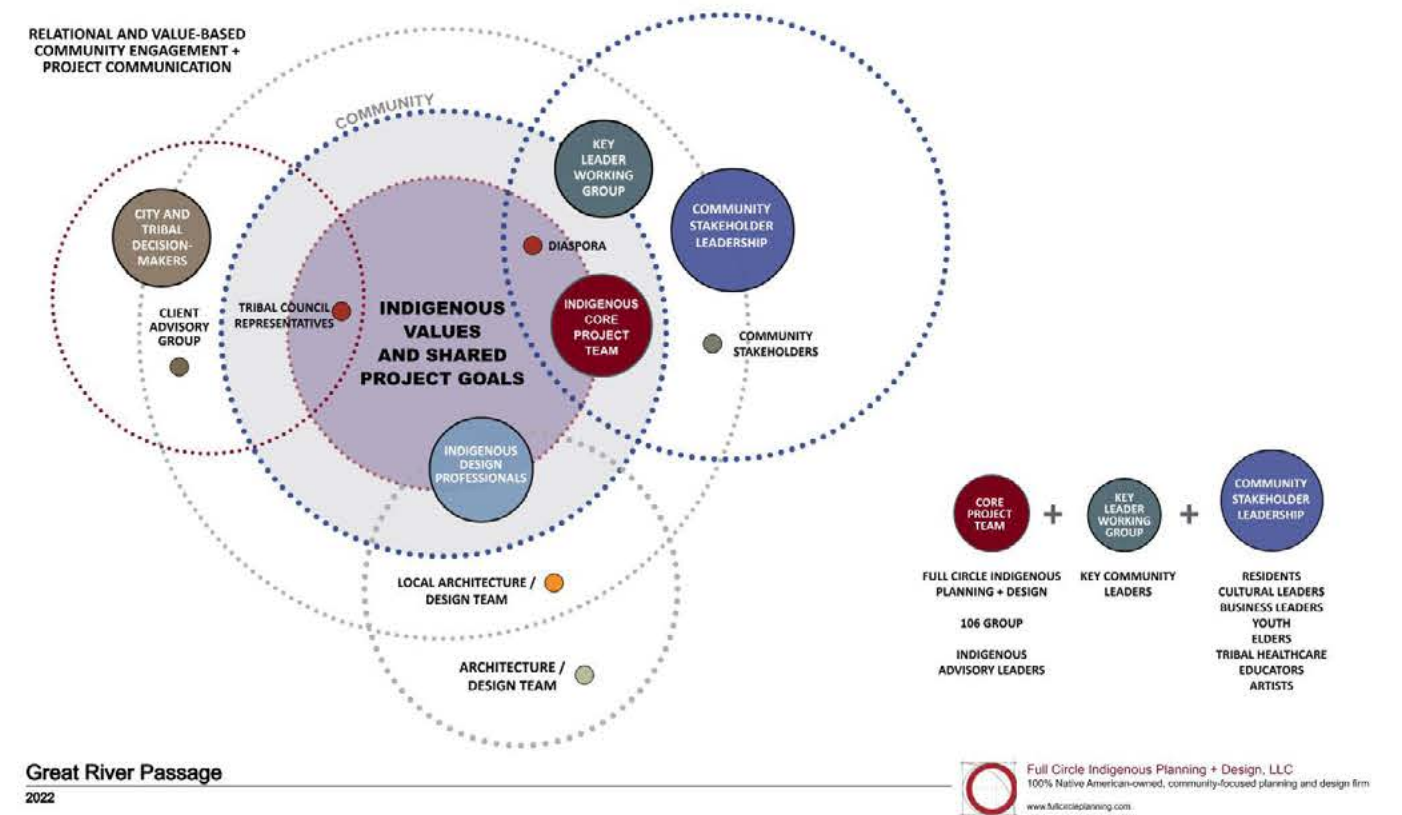

Great River Passage  
2022

# DAKOTA ENGAGEMENT INITIATIVE

Great River Passage - Partial List of Invited Indigenous Community Leadership



DAKOTA ENGAGEMENT INITIATIVE



## **Dakota insights:**

**This is not a “park.”**

**This is shared sacred community place for gathering. No one owns it.**

**This is not a single location, but part of a connected system of natural and cultural areas. Everything is related. Restore lost connections.**

**Minimize footprint of anything built here.**

**The buildings should not look like colonist structures, recalling farm structures or Fort Snelling.**

**Go beyond sustainability, be regenerative and restorative.**

**Portray the authentic history of the area, good and bad.**

**Provide areas where private ceremonies and storytelling can happen for Indigenous People.**

**Make sure Native people share in the opportunities created by this project: cultural, economic, and access.**

# PROJECT MAP

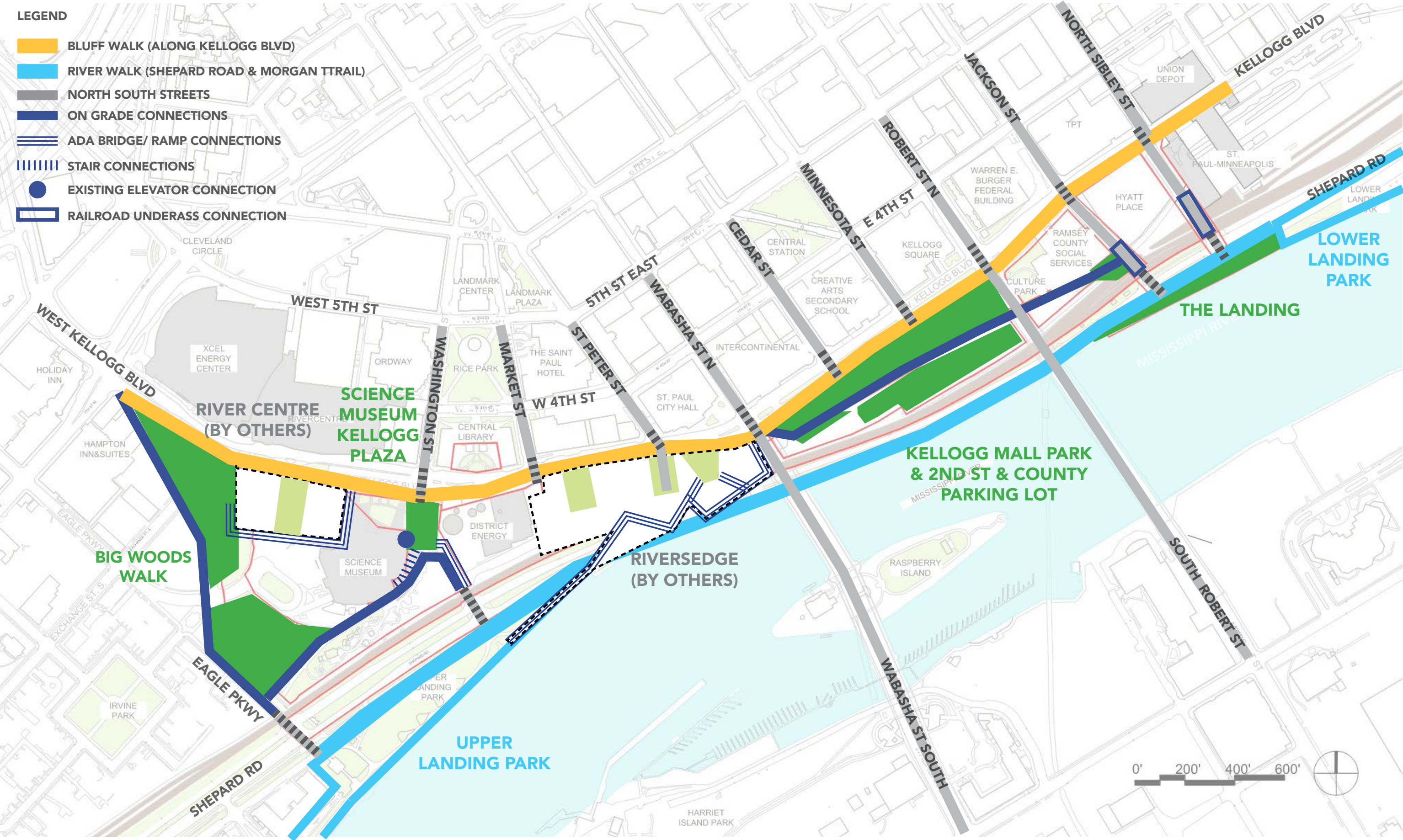

# OVERALL SITE PLAN

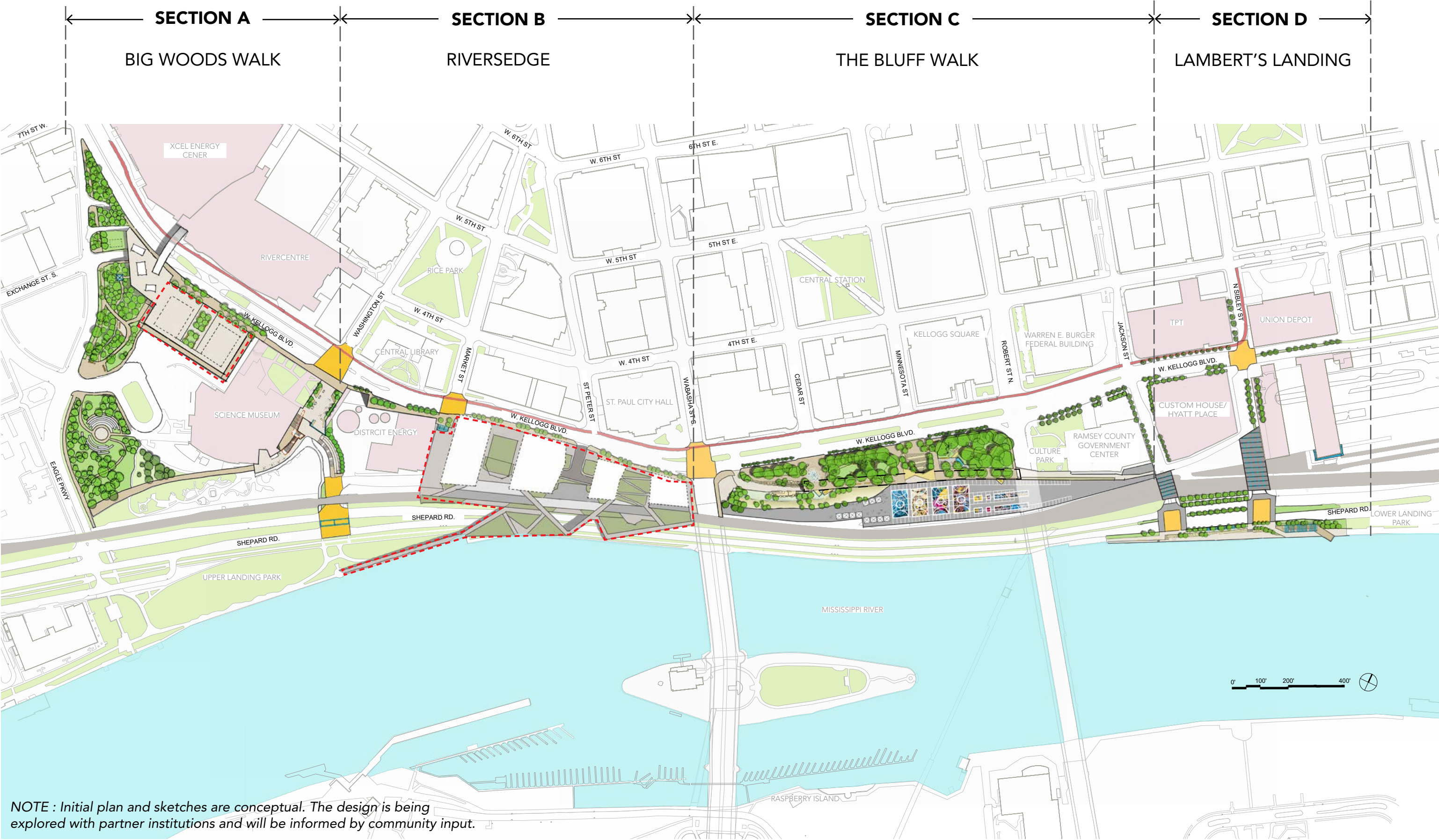

# SECTION A BIG WOODS WALK

# SITE PLAN

## BIG WOODS WALK

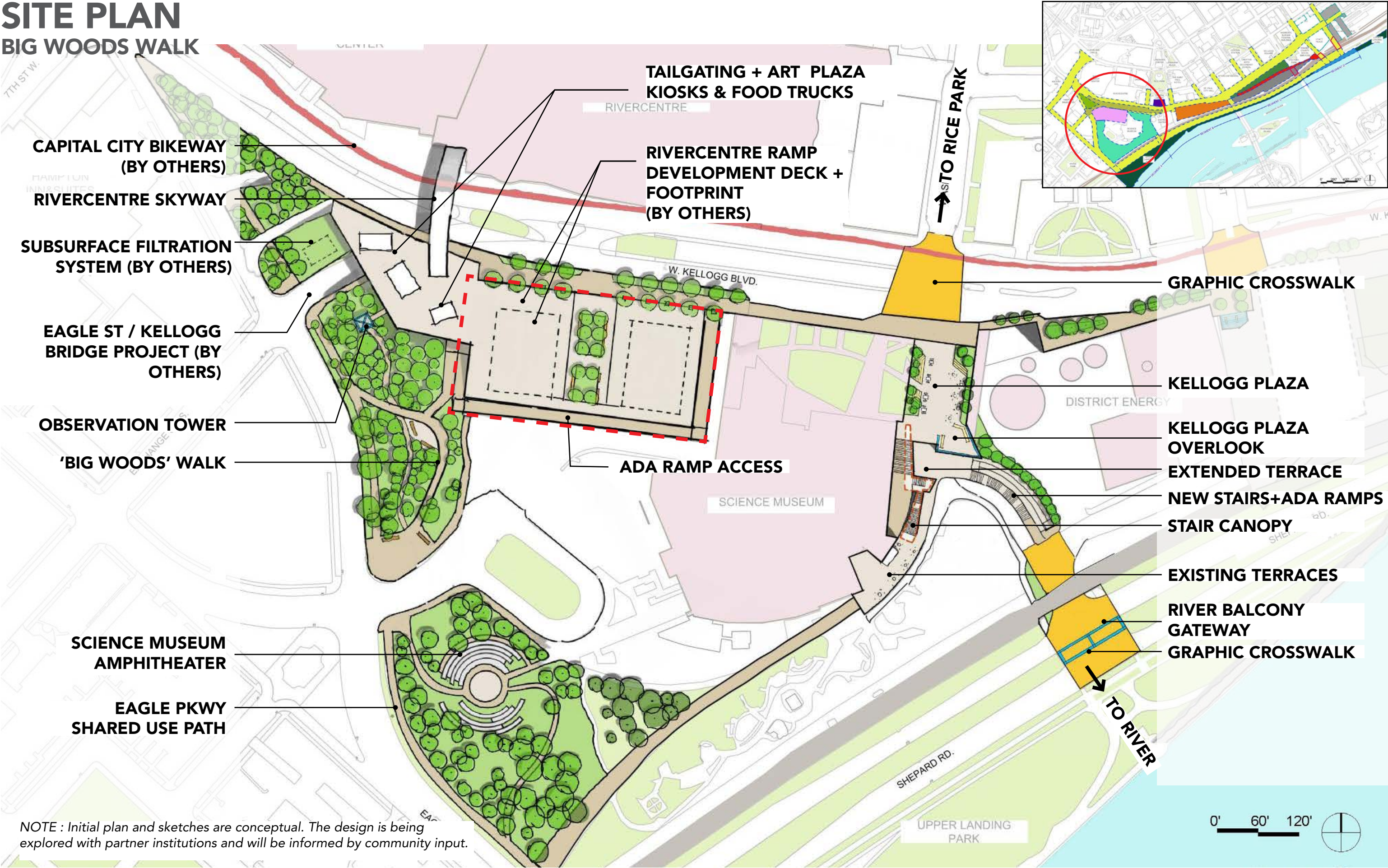

# BIG WOODS WALK & AMPHITHEATER

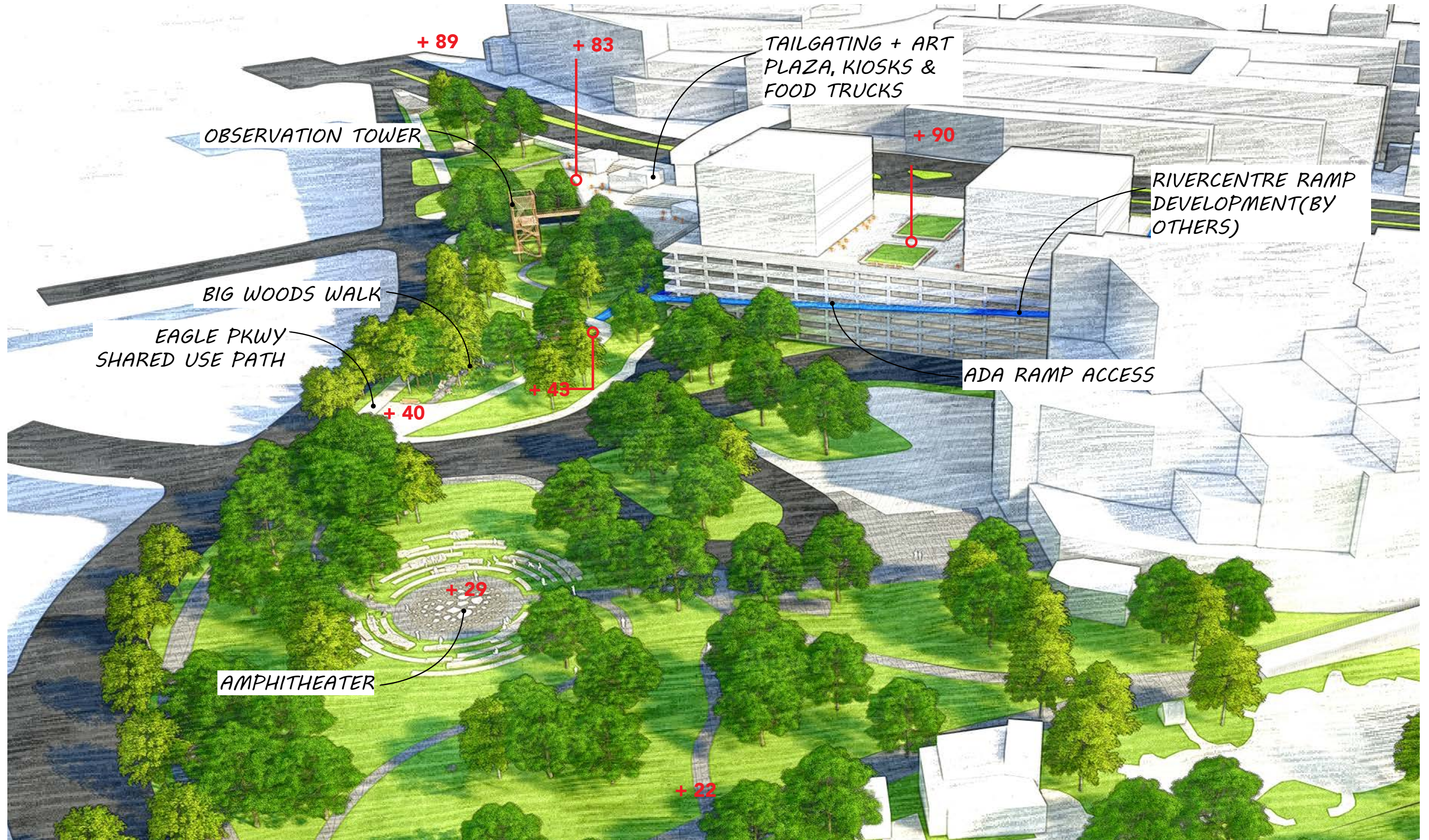

# VIEW FROM OBSERVATION TOWER



# BIG WOODS WALK

RIVERCENTRE + SCIENCE MUSEUM



# SMM AMPHITHEATER



# PRELIMINARY SKETCH

## SCIENCE MUSEUM TO RIVER CONNECTION

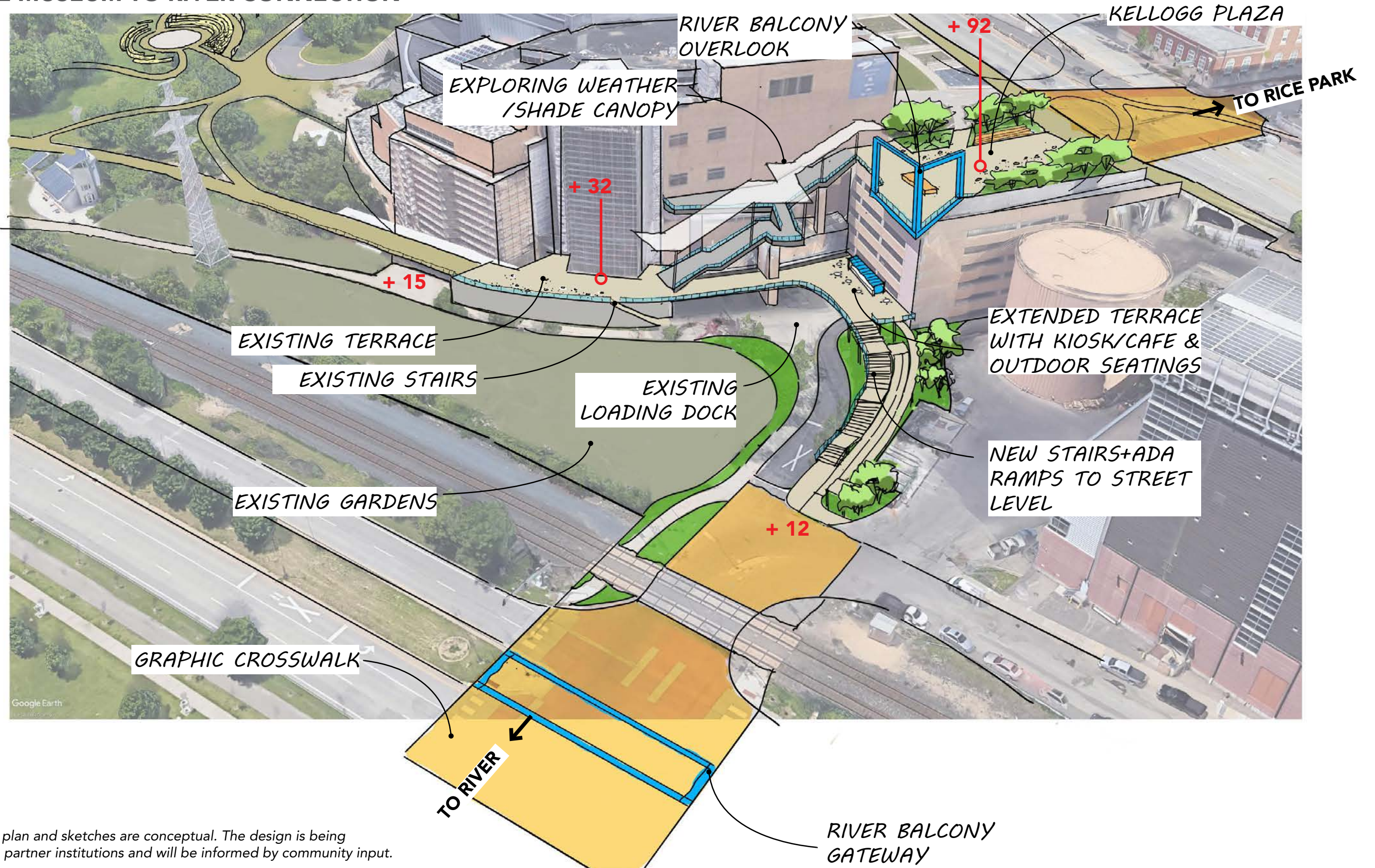

NOTE : Initial plan and sketches are conceptual. The design is being explored with partner institutions and will be informed by community input.

# KELLOGG PLAZA OVERLOOK



# SECTION B RIVERSEEDGE

# SITE PLAN

## RIVERSEEDGE

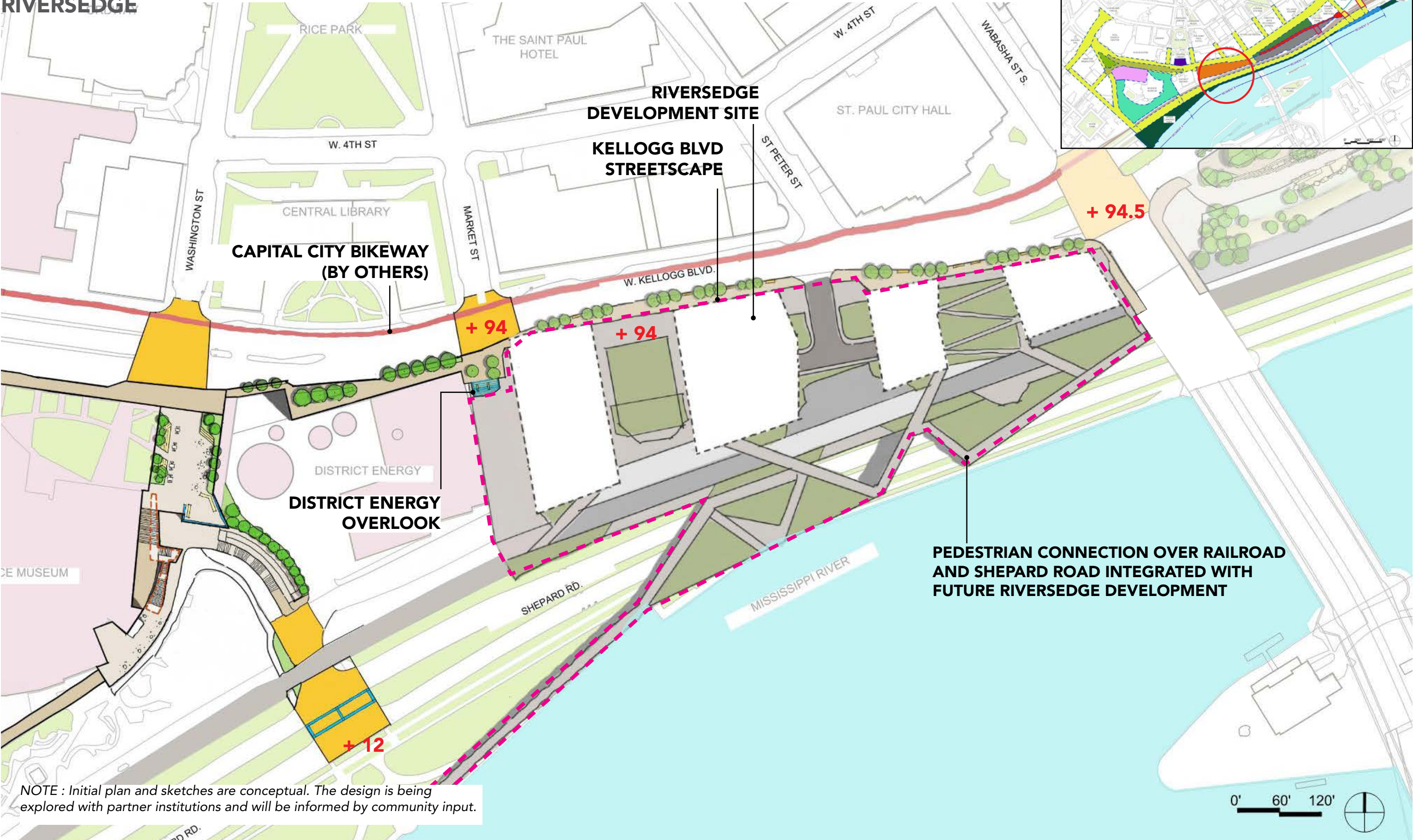

# MARKET ST. OVERLOOK



# SECTION C THE BLUFF WALK

# SITE PLAN

## THE BLUFF WALK (PARK LEVEL)

KELLOGG MALL PARK , 2ND ST CONNECTOR & COUNTY PARKING LOT



# PARK FEATURES

KELLOGG MALL PARK , 2ND ST CONNECTOR & COUNTY PARKING LOT

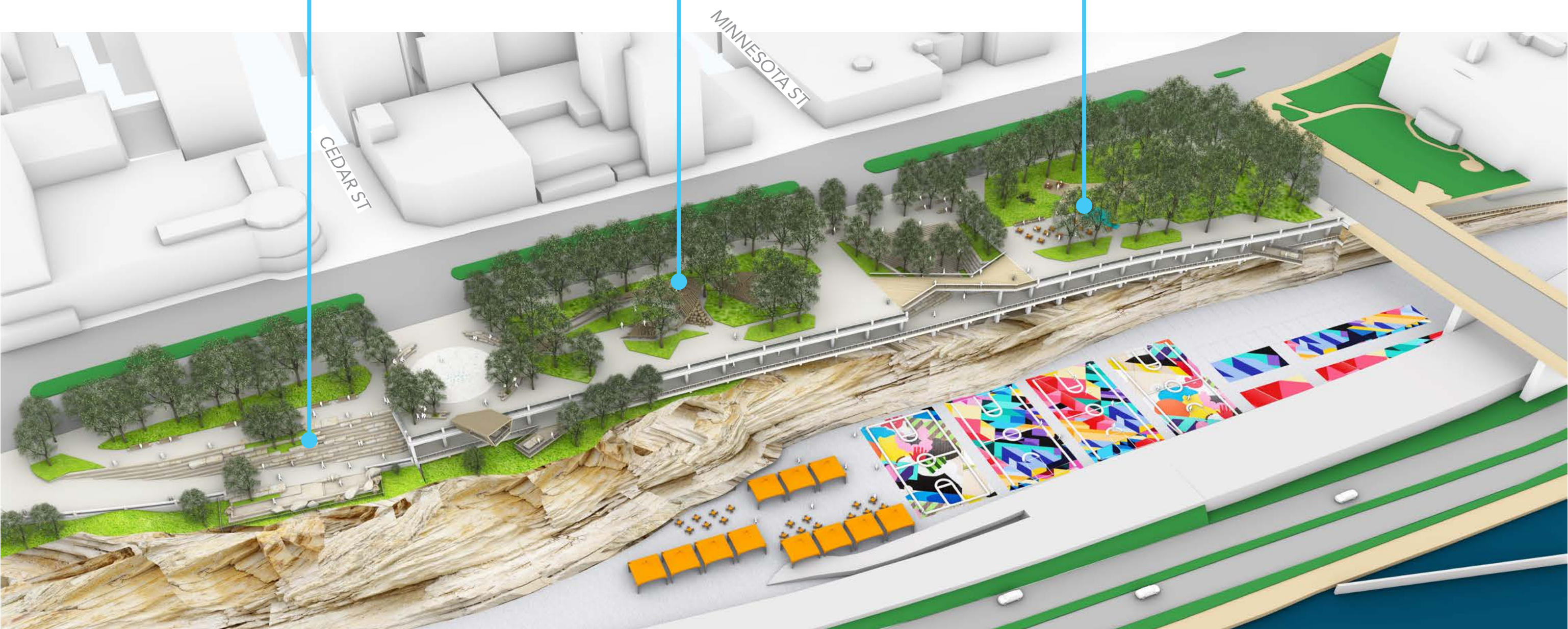
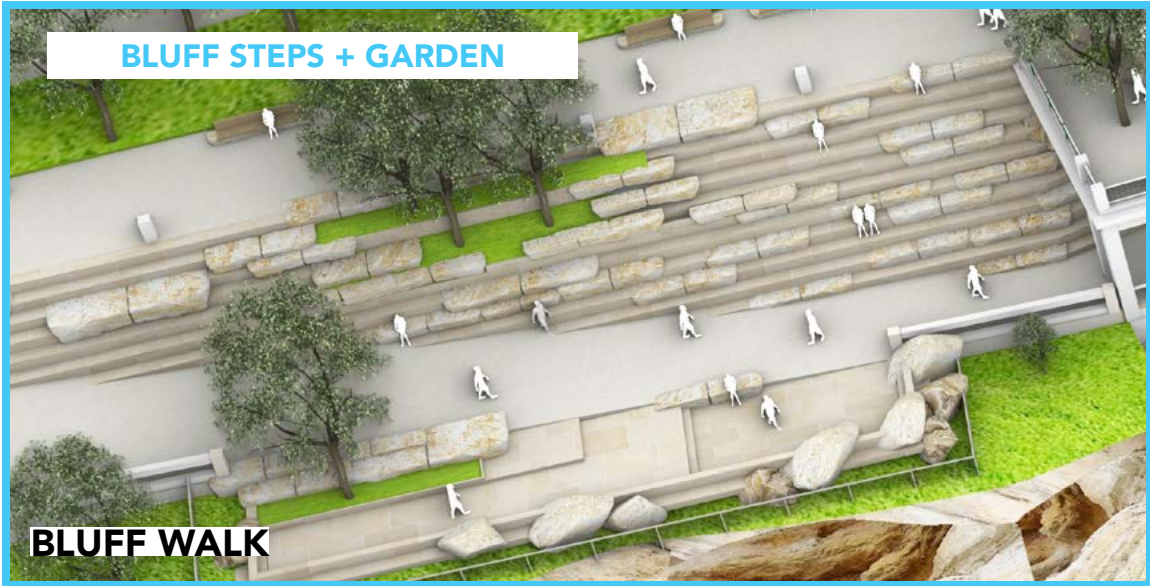

# INTERACTIVE FOUNTAIN AT CEDAR ST



# KELLOGG CUT AT MINNESOTA ST

KELLOGG MALL PARK , 2ND ST CONNECTOR & COUNTY PARKING LOT



# FOREST WALK+PICNIC

KELLOGG MALL PARK , 2ND ST CONNECTOR & COUNTY PARKING LOT



**SITE PLAN**  
**THE BLUFF WALK**  
**(2ND STREET CONNECTOR LEVEL)**



# 2ND ST CONNECTOR FEATURES

KELLOGG MALL PARK , 2ND ST CONNECTOR & COUNTY PARKING LOT

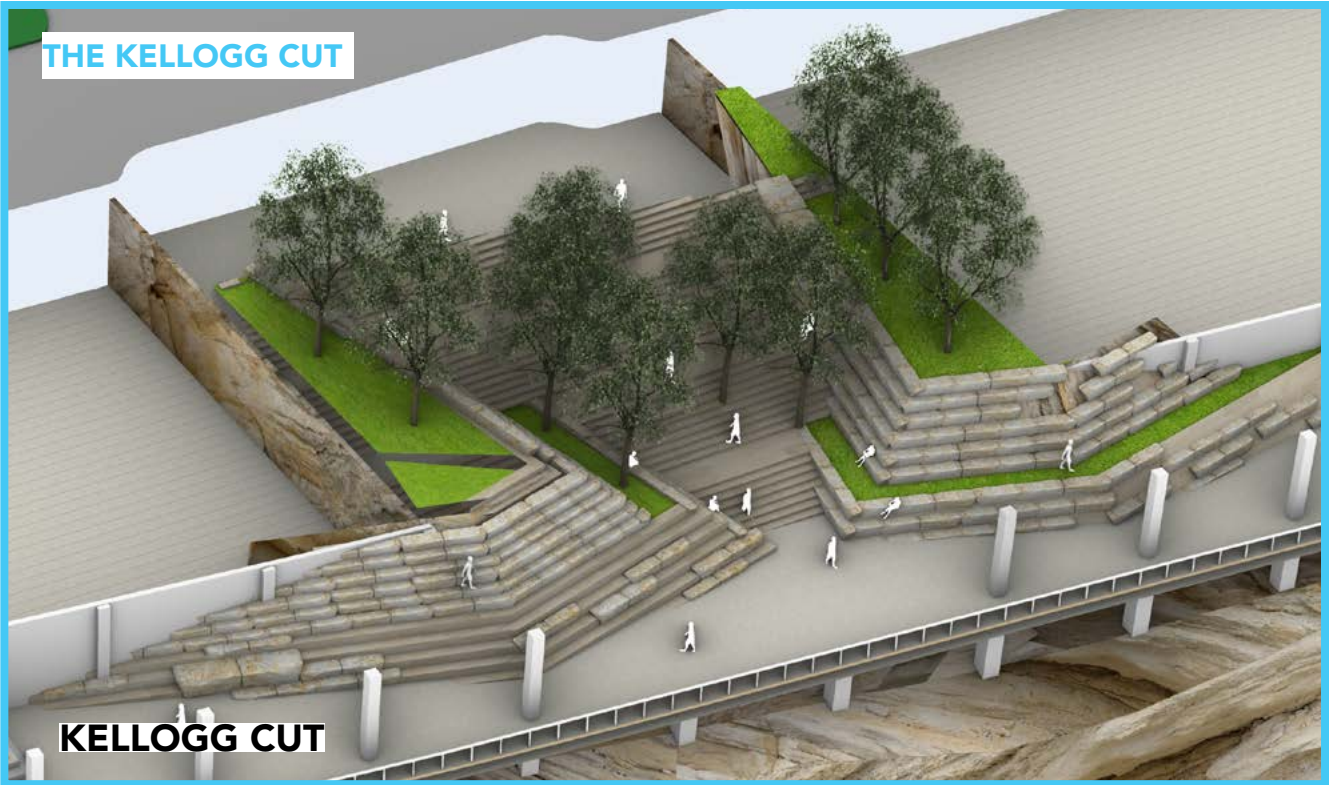

# BLUFF WALK & GARDEN



# THE CONNECTOR

KELLOGG MALL PARK , 2ND ST CONNECTOR & COUNTY PARKING LOT



# KELLOGG CUT @ E 2ND ST LEVEL

KELLOGG MALL PARK , 2ND ST CONNECTOR & COUNTY PARKING LOT

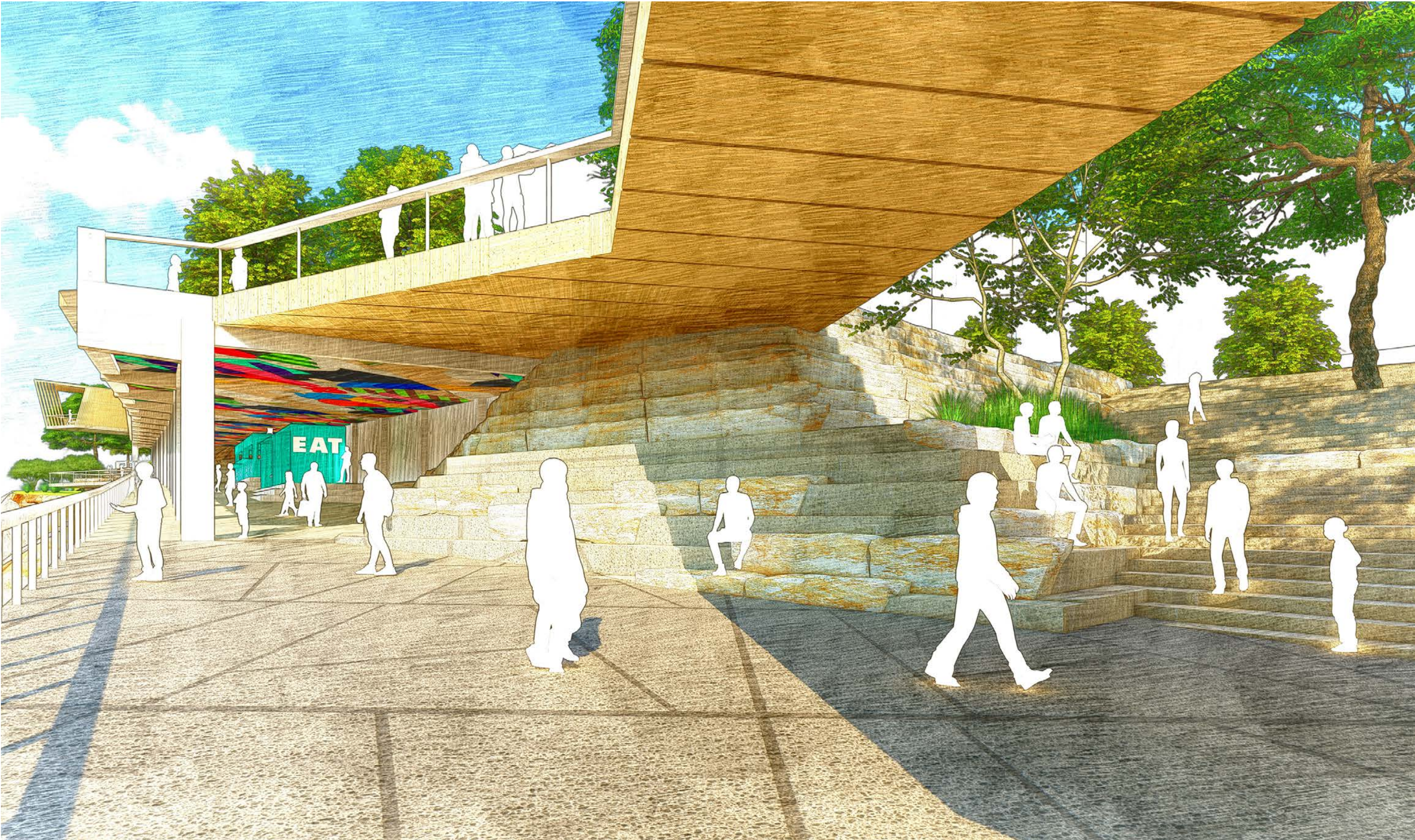

# COUNTY PARKING LOT



# SECTION D LAMBERT'S LANDING

# SITE PLAN

## LAMBERTS LANDING

LAMBERT'S LANDING & RAILROAD UNDERPASSES



SITE PLAN  
LAMBERTS LANDING

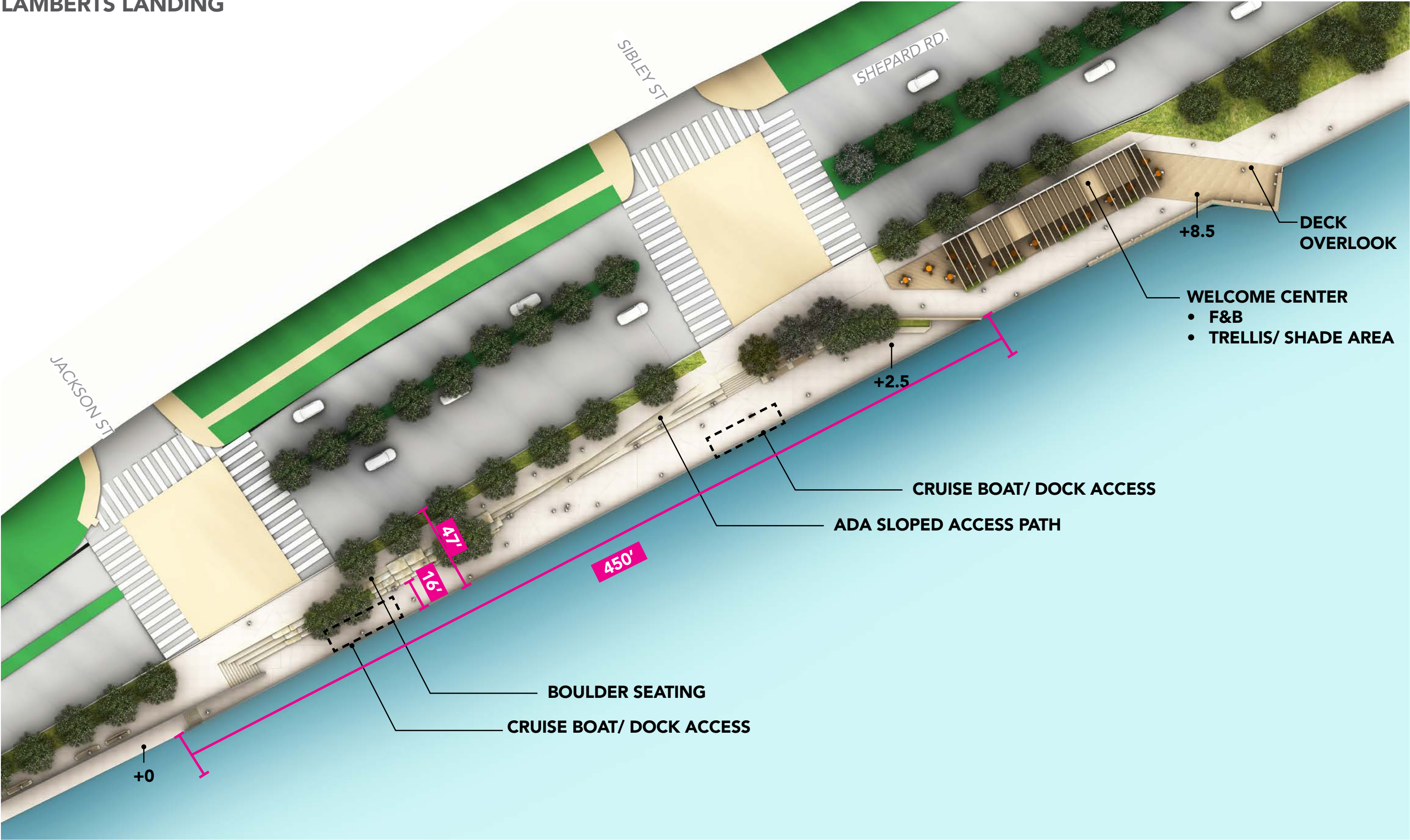

# LAMBERT'S LANDING FEATURES

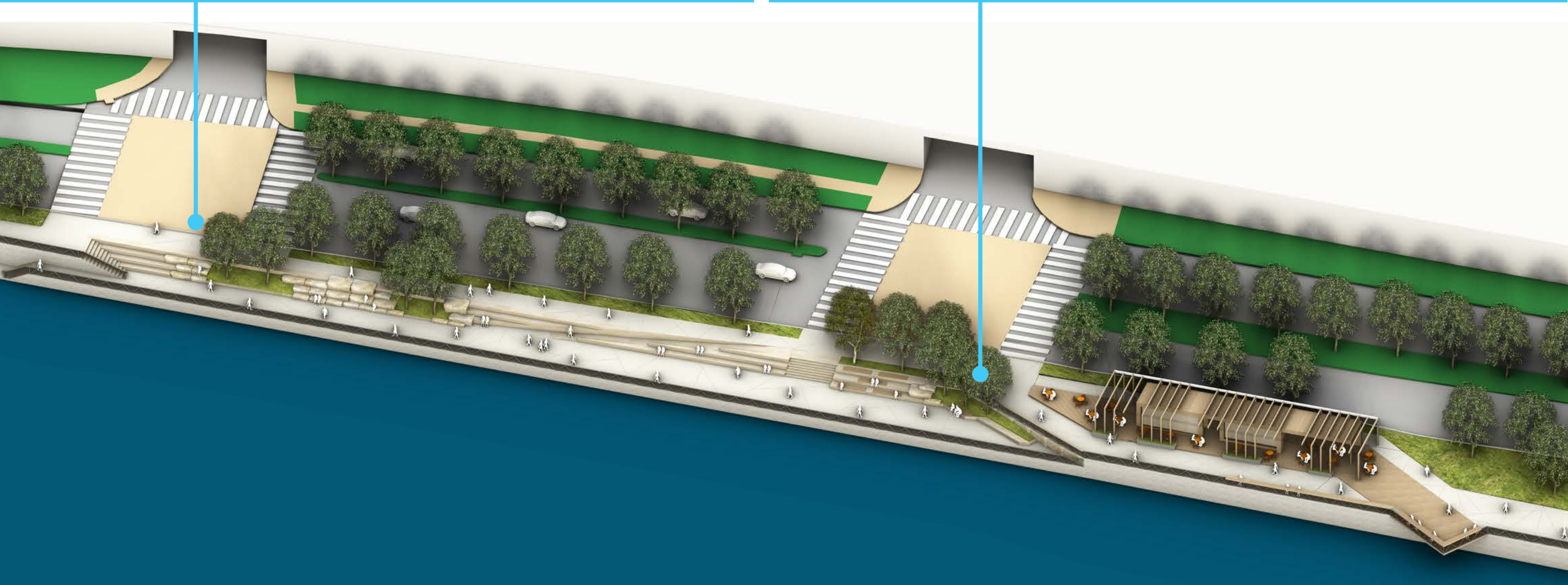
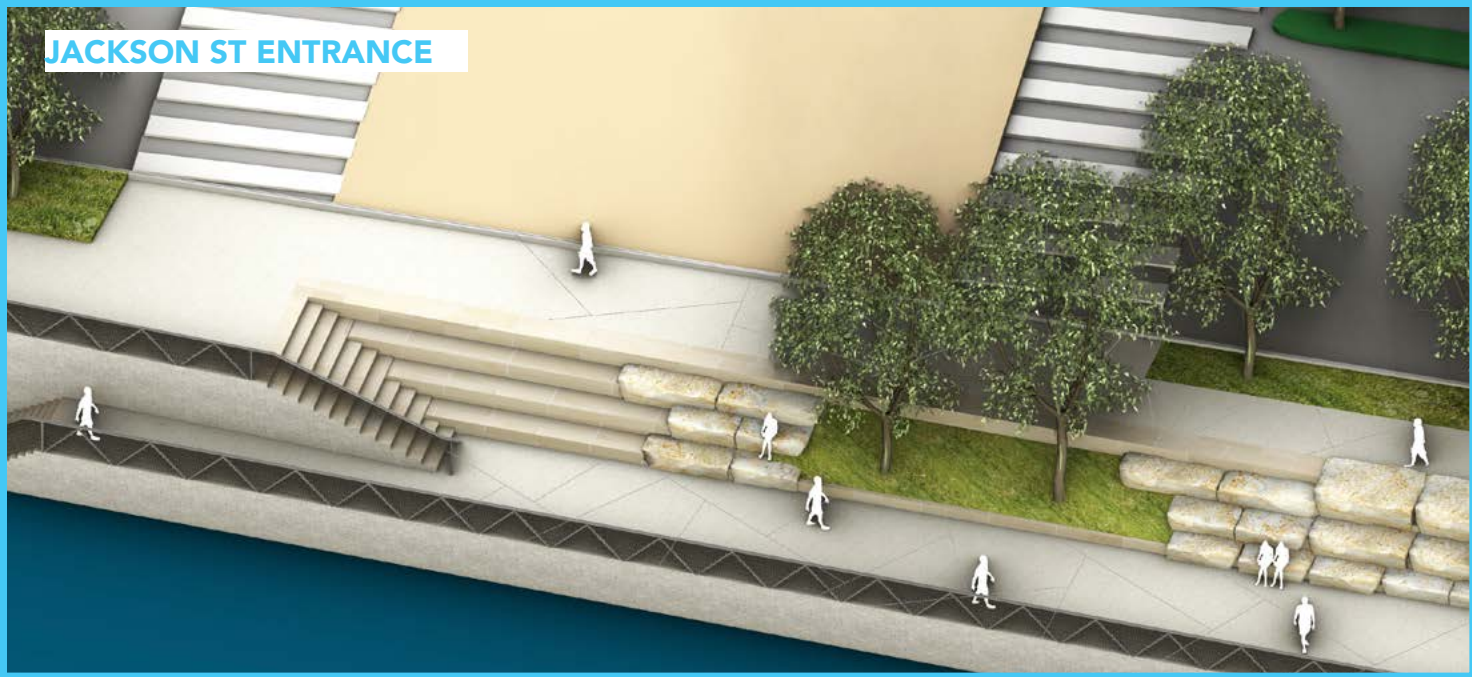

LOWER DECK



# UPPER DECK



# WELCOME CENTER & DECK OVERLOOK



# RIVER BALCONY FEATURES

